

**Notes:**  
 Do not scale from this drawing. Use figured dimensions in all cases. Verify dimensions on site and report any discrepancies to the Architect immediately.  
 This drawing is to read in conjunction with the Architect's Specifications. It is the drawing's copyright and may only be reproduced with the Architect's permission.  
**Drawing Notes:**

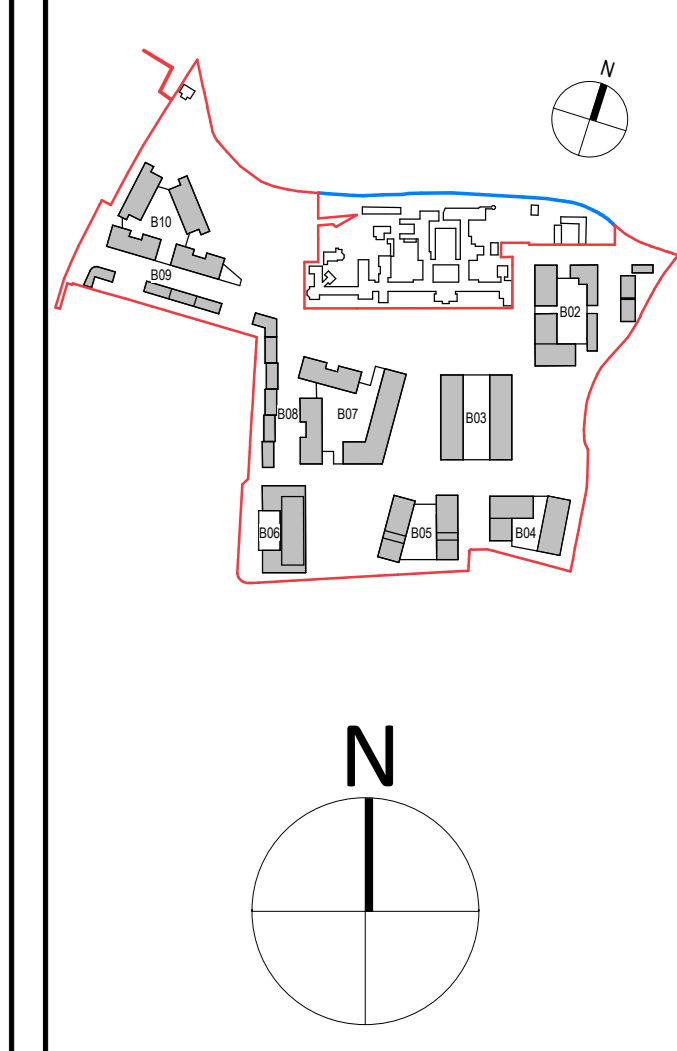

**PLANNING LEGEND**

SYMBOL	DESCRIPTION
	Site Boundary Line
	Site Ownership Line

**OSI Licence No.**  
 CYAL50407200  
 © Taithe Estrean – Surveying  
**Projection / Spatial Reference:**  
 Projections: IRENET95\_Irish\_Transverse\_Mercator  
**Centre Point Coordinates:**  
 X,Y = 717142.300532,729100.30992  
**Reference Index:**  
 Map Series | Map Sheets  
 1:1,000 | 3329-22  
 1:1,000 | 3392-02



**Client Details:**  
 Dun Laoghaire-Rathdown County Council

**Agent Details:**  
 Land Development Agency

**Project Details:**  
 Proposed Part 10 Residential Development,  
 Dundrum Central Development,  
 Dundrum Road,  
 Dublin 14

**Drawing Title:**  
 Site Plan, Existing

Job No.	Sheet Size	Scale (G.A.)
P19-233D	A0_Landscape	1: 500

Issue Date	Drawn By	Reviewed By
Sept 2024	B. Gil	R. Quinn

**Status:** Purpose of Issue  
**P3** Part 10 Planning Application

Project System	Spatial Zone	Level	Type	Originator	Role	Number	Revision
DCD-02-SW-ZZZ-DR-RAU-AR-1001							P3 S-1